

Multivette® 600 - Venous Blood Collection

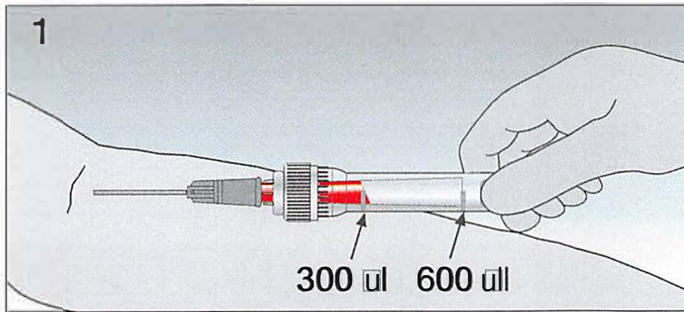

1) For venous blood collection, attach a Luer needle to the capillary tube of the Multivette®. Venous pressure alone will ensure filling of the inner tube of the Multivette®. Blood collection is complete when the blood flow reaches the end of the capillary tube (600 µl).

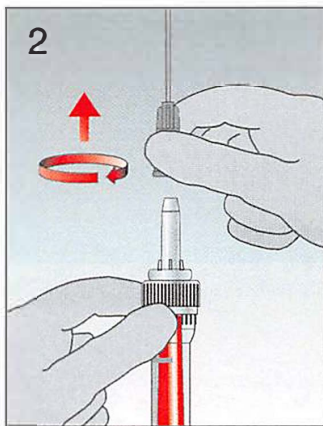

2) After venous blood collection, first detach ...

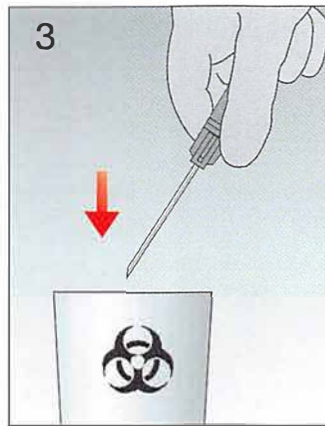

3) ... then discard the needle.

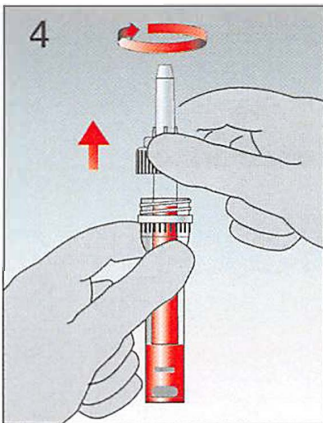

4) Draw the blood from the capillary tube into the outer micro tube by unscrewing and removing the closure and capillary as one unit.

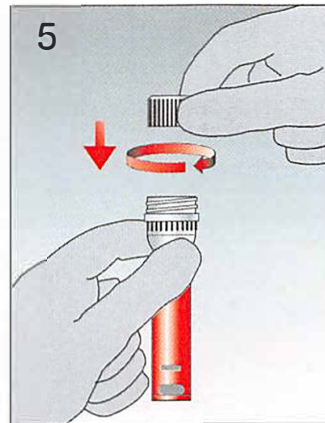

5) Close the micro tube for transport using the enclosed color-coded screw cap.



6) Mix the sample thoroughly by gently inverting the micro tube.

All patient blood specimens should be treated with standard precautions. Wear gloves!

Multivette® 600 - Capillary Blood Collection

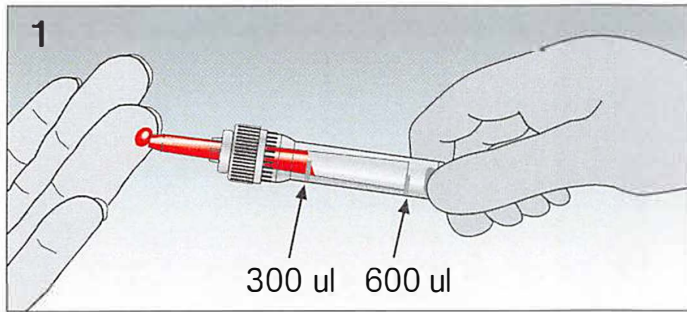

- 1) Hold the Multivette® in a horizontal or slightly inclined position and collect the blood using capillary action.

Blood collection is complete when the blood flow reaches the end of the capillary tube (600 ul).

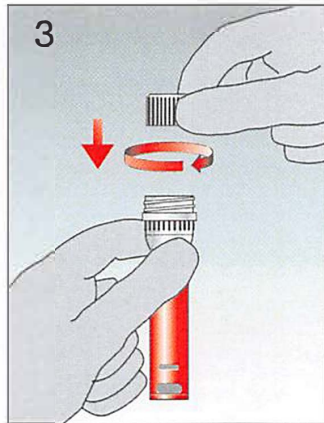
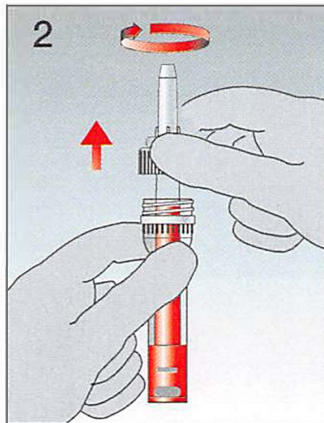

- 2) Draw the blood from the capillary tube into the outer micro tube by unscrewing and removing the closure and capillary as one unit.

- 3) Close the micro tube for transport using the enclosed color-coded screw cap.



- 4) Mix the sample thoroughly by gently inverting the micro tube.

All patient blood specimens should be treated with standard precautions. Wear gloves!

reserved

 **BRAINTREE
SCIENTIFIC, INC.**
LAB RESEARCH PRODUCTS

Your Distributor is:
Braintree Scientific, Inc.
PO Box 850498, Braintree, MA 02185
781-917-9526
Email: Info@braintreesci.com
Web: www.braintreesci.com